

Demeris Barbecue  
1702 West Loop North  
Houston, Texas 77092

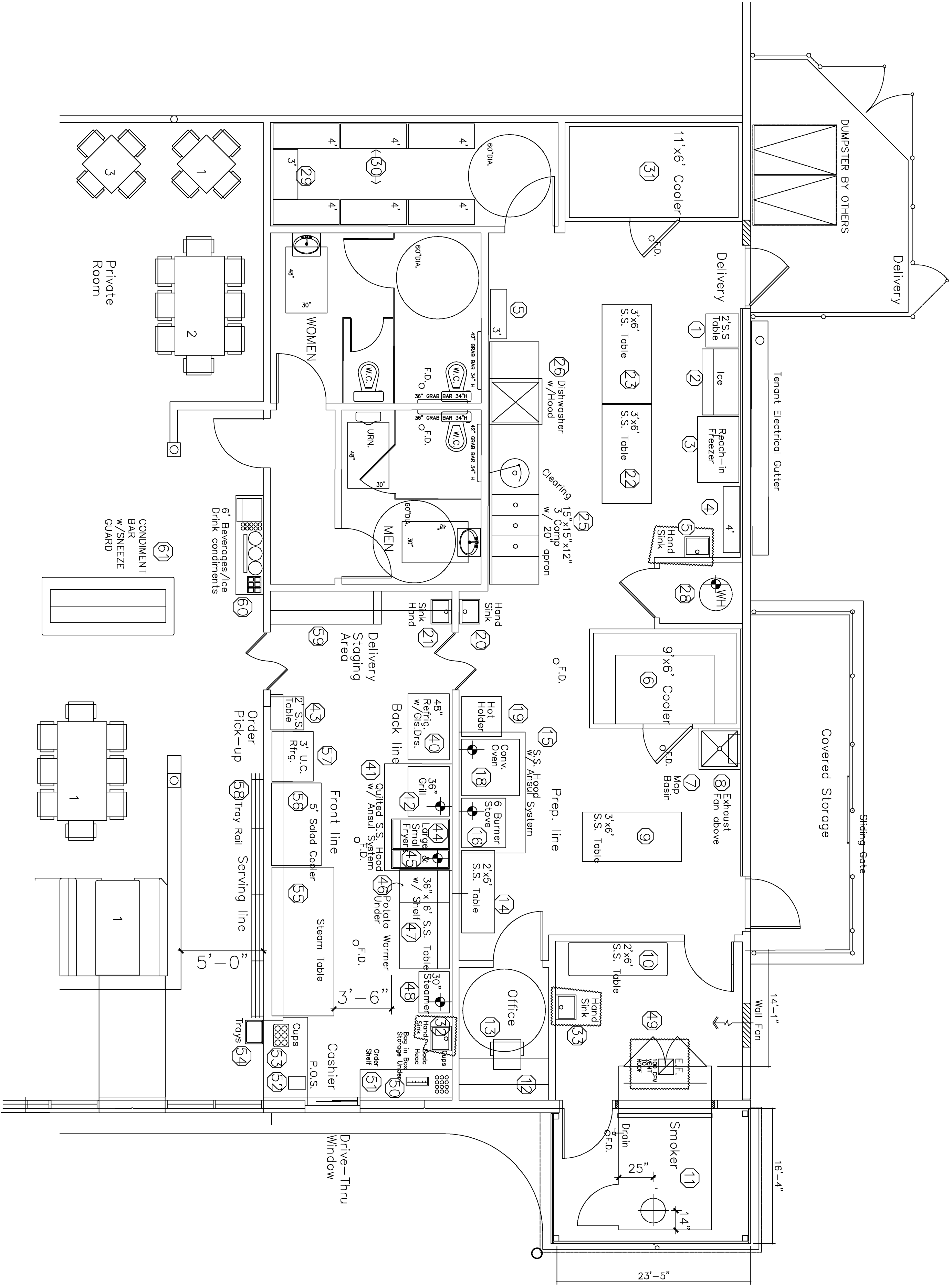

EQUIPMENT SCHEDULE — KITCHEN				
EQUIPMENT NAME	SIZE	POWER	WATER / DRAIN	NOTES
1 SS TABLE	2'x2'x36"			6" BACK SPLASH, HAS 1 LOWER SHELF
2 ICE MACHINE	4'x2'-4'x6'	220V	YES / YES	SS FINISH
3 REFRIG IN FREEZER	4'x2'-6'x6'	220V		SS FINISH
4 SS SINK, 16" WIDE	16" x 16" x 16"			SS FINISH, ON ROLLERS
5 SS SINK, 16" WIDE	16" x 16" x 16"			SS FINISH, ON ROLLERS
6 11'x6' COOLER	11'x6'x12'			SS FINISH, ON ROLLERS
7 WASHING COOLER	2'-6"x2'-6"x8"	220V	YES / YES	SS FINISH, ON ROLLERS
8 EXHAUST FAN	2'-0"x2'-0"		YES / YES	PRE-CAST CONC. UNIT W/FAUCET
9 SS TABLE	2'-6"x2'-6"			NO BACK SPLASH, HAS 1 LOWER SHELF
10 SS TABLE	2'-6"x2'-6"			NO BACK SPLASH, HAS 1 LOWER SHELF
11 SINK	6'x2'x3'			6" BACK SPLASH, HAS 1 LOWER SHELF
12 DESK				
13 CHAIR				
14 SS TABLE	5'x2'x3'			6" BACK SPLASH, HAS 1 LOWER SHELF
15 EXHAUST HOOD	7'-4"x4'	220V		ANSEL SYSTEM & MAKE-UP AIR
16 EXHAUST HOOD	7'-4"x4'	220V		ANSEL SYSTEM & MAKE-UP AIR
17 SS TABLE	7'-4"x4'			NO BACKSPLASH
18 CONNECTION OVEN	3'-6"x2'-6"	GAS/110V		FREE STANDING
19 HOT HOLDER	2'-6"x2'-6"	110V		SS FINISH, ON ROLLERS
20 HAND SINK	1'-0"x1'-6"		YES / YES	STAINLESS STEEL ACCESS. PACK. MIXG. VALVE
21 HAND SINK	1'-0"x1'-6"		YES / YES	STAINLESS STEEL ACCESS. PACK. MIXG. VALVE
22 SS TABLE	6'x3'x3'			NO BACK SPLASH, HAS 1 LOWER SHELF
23 SS TABLE	6'x3'x3'			NO BACK SPLASH, HAS 1 LOWER SHELF
24 NOT USED				
25 3 COMP. & FINISH SINK	15'x5'x12'		YES / YES	6" BACK SPLASH, BOU PLANE ON END
26 DISHWASHER	2'-5'x2'x10'	220V	YES / YES	COMBINATION W/ 225
27 SS TABLE	6'-8'x3'x3'			6" BACK SPLASH
28 SS TABLE	6'-8'x3'x3'			
29 SS SINK	16'x4'x6'	GAS	WATER / NONE	SS FINISH
30 SS SINK	16'x4'x6'	GAS	WATER / NONE	SS FINISH
31 WALK-IN COOLER	11'x6'x1'-6"	220V	NONE / YES	ALUM. FINISH, FREEZING
32 HAND SINK	1'-0"x1'-6"		YES / YES	STAINLESS STEEL ACCESS. PACK. MIXG. VALVE
33 HAND SINK	1'-0"x1'-6"		YES / YES	STAINLESS STEEL ACCESS. PACK. MIXG. VALVE

EQUIPMENT SCHEDULE — LINE				
EQUIPMENT NAME	SIZE	POWER	WATER / DRAIN	NOTES
40 EXHAUST HOOD	6'-6"x2'-1"	220V		ANSEL SYSTEM & MAKE-UP AIR
41 EXHAUST HOOD	6'-6"x2'-1"	220V		ANSEL SYSTEM & MAKE-UP AIR
42 GRILL	3'x2'-6"	GAS		
43 SS TABLE	2'x2'x3'			6" BACK SPLASH, 1 LOWER SHELF
44 SS TABLE	1'-10'x3'-6"	GAS		SS FINISH
45 LARGE FRYER	1'-10'x3'-6"	GAS		SS FINISH
46 SMALL FRYER	1'-10'x3'-6"	GAS		SS FINISH
47 SS TABLE	6'x3'x3'	110V		6" SPLASH W/UPPER & LOWER SHELF
48 STEAMER	2'-6'x1'-10"	110V		SS FINISH
49 SMOKE VENT HOOD	12'x6'-0"	SS		100 CFM VENT TO ROOF
50 SODA HEAD	1'-4'-6"	110V	YES / YES	4" SPLASH, 2 LOWER DRS & SHELFS
51 ORDER CABINET	9'-6'x1'-6"	110V		REFRESHER INTO COUNTERTOP
52 TEA GLASS SERVER	PER MANUF.			REFRESHER
53 TRAY RACK	9'x3'-9"	110V		SS FINISH
54 SS TABLE	9'x3'-9"	110V		SS FINISH
55 SALAD COOLER	3'x2'-6"	110V		SS FINISH
56 UNDERCOUNTER FROG	3'x2'-6"	110V		SS FINISH
57 UNDERCOUNTER FROG	3'x2'-6"	110V		SS FINISH
58 DELIVERY STAGE CAB	11'x2'x2'			4" SPLASH, 2 LOWER SHELF, 6 DRS
59 DRINK/CONDIMENT	6'x1'-10"		YES / YES	4" SPLASH, 2 LOWER SHELF, 4 DRS
60 DRINK/CONDIMENT	6'x1'-10"		YES / YES	4" SPLASH, 2 LOWER SHELF, 4 DRS
61 CONDIMENT ISLAND	8'x3'-5"	110V	YES / YES	2 LOWER SHELF, 4 DRS FA SIDE

THESE DRAWINGS ARE INSTRUMENTS OF SERVICE AND ARE THE PROPERTY OF ROBERT HOOVER ARCHITECTS, P.C. ALL RIGHTS ARE RESERVED. NO PART OF THESE DRAWINGS ARE TO BE REPRODUCED OR TRANSMITTED IN ANY FORM OR BY ANY MEANS, ELECTRONIC OR MECHANICAL, INCLUDING PHOTOCOPYING, RECORDING, OR BY ANY INFORMATION STORAGE AND RETRIEVAL SYSTEM, WITHOUT THE WRITTEN CONSENT OF ROBERT HOOVER ARCHITECTS, P.C. © 2011 COPYRIGHT BY ROBERT HOOVER, AIA. ALL RIGHTS RESERVED.